

Location Plan

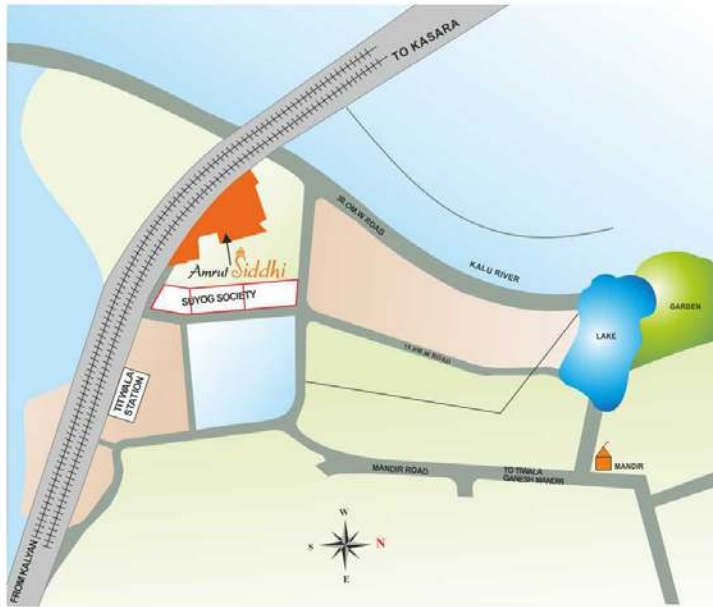

Site: "Amrut Siddhi", Sumukhsha Soc., Near Railway Station, Near Krishna Bhagwan Soc., Titwala (E). Call: 0251 2380183 / 84 | 96198 88270 | 96198 88271

Developers
Jayshree Builders
Thane

Architect
Anil Nirgude
Vitant Consultant

RCC Consultants
Anand Kulkarni
Epicons

Legal Advisor
Sailendra Jalawar
Law Mens

Our Prestigious Projects



Amrut Angan
Kalwa
(11 Tower)



Amrut Heaven
Kalyan
(300 Flats)



Amrut Park
Kalyan
(300 Flats)



Amrut Palm
Kalyan
(100 Flats)



Yogi Dham
Kalyan
(3o Towers, 200 Flats)



Off: 1st Flr, Jugalbaug Compound, Opp. S.T. Workshop, L. B. S. Marg, Thane (W) 400 601.
Email: info@mehtagroup.net.in | Web: www.mehtagroup.net.in

Disclaimer: The plans are subject to changes / modifications / amendments (without notice) for better layout, as per the suggestions of the Architect and/or as per requirement of the concerned authorities. All the amenities, facilities etc., are subject to the approval of the concerned authorities and subject to the changes, if required.
All renderings and maps are artists impressions and not actual depiction of the buildings or landscaping. Developer does not warrant or assume any legal liability or responsibility for the accuracy or completeness of any information disclosed



Amrut Siddhi
Titwala (East).

Enter the world of divine charm...



Amrut Siddhi

Titwala (East).

Project Highlights:

- Stilt + 14 Storey of 5 Towers • Stilt + 7 Storey of 9 Towers • 1 & 2 BHK Terrace Flats
- 550 Flats Township • 1min. walk from station

TITWALA BEGINS A NEW JOURNEY AMIDST NATURE.

The minute you enter Titwala, a stroke of fresh air rejuvenates you. Situated amidst lush greenery, this suburban locale is sprouting rapidly with development, and shimmering with a bright future. A natural beauty in the concrete jungle, Titwala is also known for the historic Mahaganpati Temple. With so much to offer, it is an ideal place to own a house and begin a journey amidst nature.



A project developed by the renowned Mehta Group, Amrut Siddhi is the newest addition to the homes they have been constructing since the past four decades. A complete residential complex located at Titwala, Amrut Siddhi consists of 14 magnificent towers with 550 flats, taking you to a different world altogether.

LOCATION ADVANTAGE:

- Railway station just a minute away
- Easy access to schools, colleges and temples
- Daily market at a stone's throw distance
- Pollution free environs





Stilt + 14 Storey - 5 Towers



Bld. No 14

Bld. No 13

WING - A

TYPICAL FLOOR PLAN
(2nd, 4th, 6th, 10th, 12th & 14th Floor)

WING - B



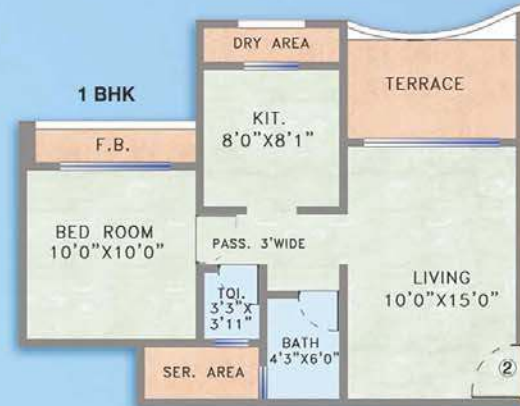

Railway Side



7

8

9

TYPICAL FLOOR PLAN
(1st, 3rd & 7th Floor)
Garden Side

Stilt + 7 Storey - 9 Towers



EVERYTHING YOU NEED AND A HUG FROM NATURE!



Internal Amenities

- 2' x 2" Vitrified tiles in all rooms
- Black granite platform in kitchen with S. S. sink & full height tiles dado
- Low level powder coated sliding window in all rooms
- Quality loft tank with concealed connection in common toilet
- Premium quality fixtures in all toilets with concealed plumbing

- Generator for lift, pump, staircase & surrounding lights
- Intercom connection
- Concealed electric wiring
- External waterproof water resistance apex paint and internal emulsion paint



WHEN LUXURY AND NECESSITIES
COME TOGETHER TO GIVE
YOU HAPPINESS.



Facilities:

- Landscape Garden
- Gym • Children's Play Area
- Jogging Track • Indoor Games
- Intercom Security • Badminton Court
- Tennis Court • Pool Table • Table Tennis

CLUB HOUSE

